





A large detached house presented in good order and set in extensive gardens adjacent to St John's Church.

Size: 2,292 sq ft

Council Tax: Wiltshire £3692.41 (2025/26), Band F



Dilapidation Deposit: Equivalent to 5 weeks' rent, to be held by The Deposit Protection Service for the duration of the tenancy.

Holding Deposit: Equivalent to one weeks' rent.

Services: Mains gas, electricity, water and telephone.

Other Fees: See Website.

St John's Vicarage, 340 Frome Road, Studley Trowbridge, Wiltshire, BA14 0ED

- Detached House
- Double Garage
- Close to Town Centre
- Large Garden
- Driveway parking
- Available for a 6 month initial tenancy only
- Pet friendly

The Property

The Vicarage sits in the centre of a good sized plot with a private garden wrapping round the house, adjacent to the picturesque St John the Evangelist churchyard.

The accommodation is light and airy, recently redecorated and consists of an entrance hallway, office, cloakroom, dining room, sitting room with open fireplace kitchen breakfast room, and utility area. Parquet flooring runs through the the principle ground floor rooms with carpets to the bedrooms and office. There is an attached double garage, accessed via the utility.

On the first floor, off a large landing are four double bedrooms, all with built in wardrobes, and en suite shower room to Bedroom 1 and a family bathroom.

To the front of the property is a large driveway, providing parking for several vehicles in addition to the garage. The extensive garden, which is mainly laid to lawn with some mature trees and shrubs, wraps round on three sides of the house.

Location

St Johns Vicarage is situated on the outskirts of Trowbridge, close to many local amenities including primary and secondary schools. Just a short walk away is the popular Southwick Country Park. Trowbridge town centre is within easy reach, providing excellent shopping and leisure facilities, including a multiplex cinema, sports centre and variety of pubs and restaurants.

Trowbridge railway station provides regular services to Salisbury, Southampton, Bath & Bristol. Westbury train station (5 miles) offers direct services to London Paddington.

Tenancy & Restrictions

To be let unfurnished on an Assured Shorthold Tenancy (minimum term of 6 months, thereafter on a monthly basis if allowed). No smokers or sharers.





Energy Efficiency Rating		
Very energy efficient - lower running costs	Current	Potential
A (92 plus)		
B (81-91)		
C (69-80)		
D (55-68)		
E (39-54)		
F (21-38)		
G (1-20)		
Not energy efficient - higher running costs		
England & Wales	EU Directive 2002/91/EC	

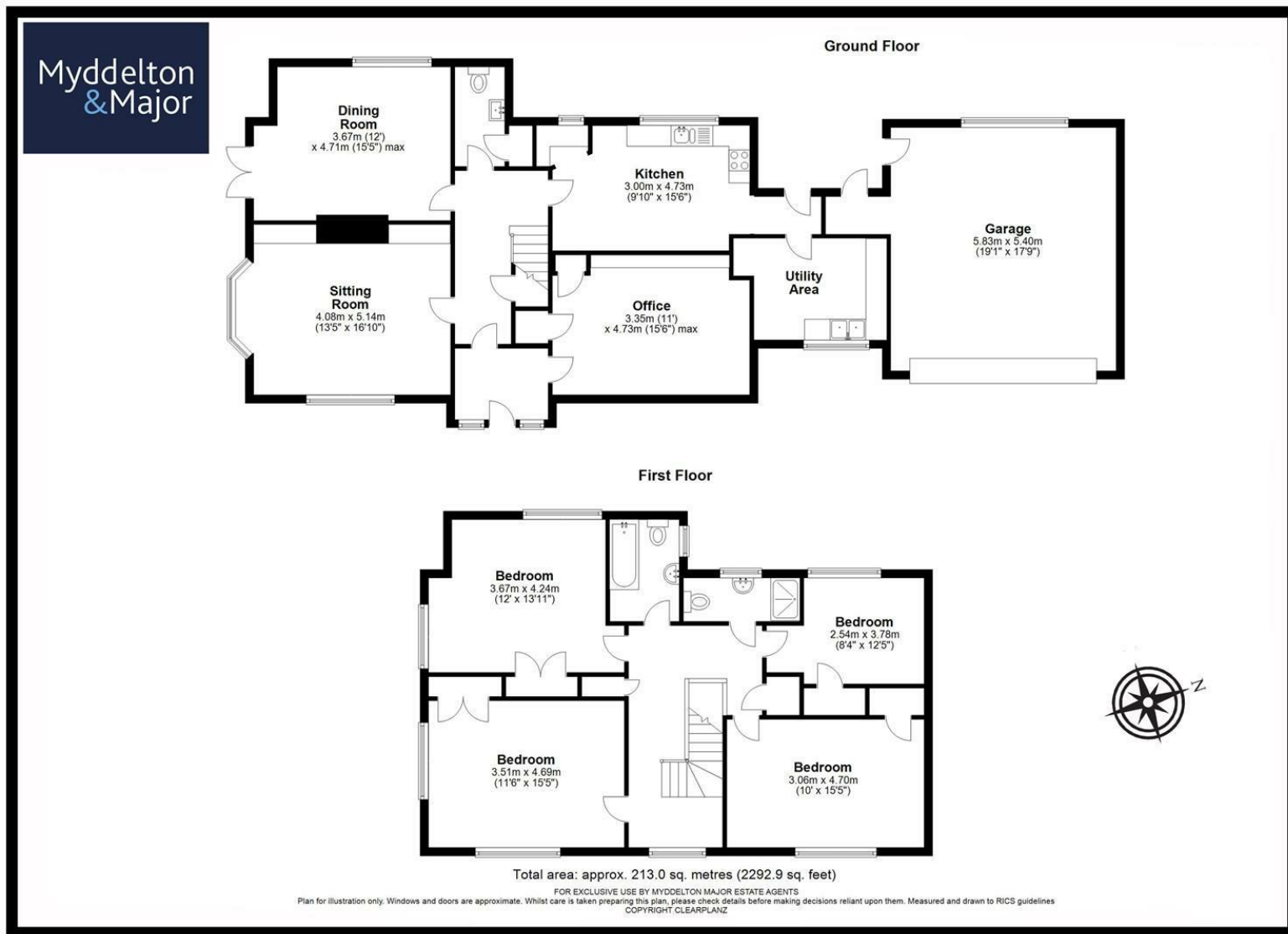

Disclaimer Notice:

Myddelton & Major and their clients give notice that:- i) they have no authority to make or give any representations or warranties in relation to the property, ii) these particulars do not form part of any offer or contract and must not be relied upon as statements or representation of fact. iii) any area, measurement or distances are approximate. The text, photograph and plan are for guidance only and are not necessarily comprehensive. It should not be assumed that the property has all the necessary planning, Building Regulation or other consents, and, any services, equipment or facilities have not been tested by the agent. iv) the purchaser must satisfy themselves by inspection or otherwise.



49 High Street, Salisbury, Wiltshire SP1 2PD
01722 337 579 lettings@myddeltonmajor.co.uk
www.myddeltonmajor.co.uk

Myddelton & Major